

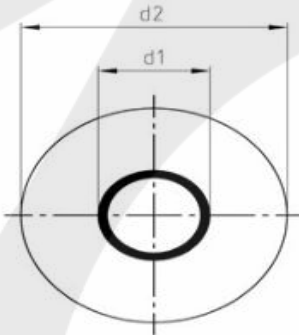

## METAL BONDED SEALING WASHER

## Catalogue Datasheet J2D50-4

**SS A4 (SS316) - EPDM**

Quote the item code given below with your order/ inquiries:

Dimensions in mm

| Screw Size | Item Code   | Inner Diameter | Outer Diameter |
|------------|-------------|----------------|----------------|
| d          |             | d1             | d2             |
| #10 ST4.8  | J2D50408412 | 4.8            | 12             |
|            | J2D50408414 | 4.8            | 14             |
| #12 ST5.5  | J2D50503412 | 5.3            | 12             |
|            | J2D50503414 | 5.3            | 14             |
|            | J2D50503416 | 5.3            | 16             |
|            | J2D50503419 | 5.3            | 19             |
| #14 ST6.3  | J2D50602416 | 6.2            | 16             |
|            | J2D50607416 | 6.7            | 16             |
|            | J2D50607419 | 6.7            | 19             |
|            | J2D50607422 | 6.7            | 22             |
|            | J2D50607425 | 6.7            | 25             |
|            | J2D50607429 | 6.7            | 29             |
| #16 ST8.4  | J2D50804416 | 8.4            | 16             |
|            | J2D50804419 | 8.4            | 19             |
|            | J2D50804422 | 8.4            | 22             |
|            | J2D50804425 | 8.4            | 25             |
|            | J2D50804429 | 8.4            | 29             |
| ST10.5     | J2D50105425 | 10.5           | 25             |
|            | J2D50105429 | 10.5           | 29             |
| ST13.0     | J2D50130429 | 13.0           | 29             |

Sizes in BLUE are non-preferred. Availability is limited and MOQ is higher.

Data is strictly informative

**Note:** All Austenitic Stainless Steel Fasteners may exhibit some magnetic properties due to the manufacturing process.

Refer: ISO 3506-2 Annex F