



J.C. GUPTA & SONS

GSTIN : 29AABFJ2719C1ZO
IEC : 00710030274

Fastener Super Speciality

#7/A, Sree Venkateshwara Building, Sadar Patrappe Road, Bengaluru - 560002

41478141, 9880539870 www.jcfasteners.com sales@jcfasteners.com

DIN 988 SHIM RINGS



Catalogue Datasheet **B4D41**

Stainless Steel A2/1.4301 (SS304)

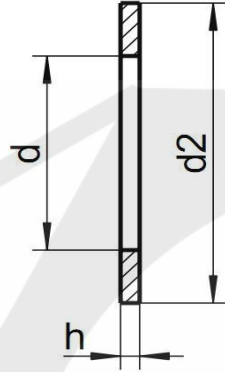
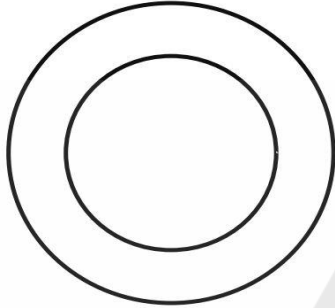

Quote the item code given below with your order/ inquiries

Dimensions in mm

Inside dia d		Outer Dia d2		Thickness h				
nom	min-max	nom	min-max	0.1	0.2	0.3	0.5	1.0
3	3.02-3.12	6	5.85-5.97	B4D4103001	B4D4103002	B4D4103003	B4D4103005	B4D4103010
4	4.03-4.15	8	7.81-7.96	B4D4104001	B4D4104002	B4D4104003	B4D4104005	B4D4104010
5	5.03-5.15	10	9.81-9.96	B4D4105001	B4D4105002	B4D4105003	B4D4105005	B4D4105010
6	6.03-6.15	12	11.77-11.95	B4D4106001	B4D4106002	B4D4106003	B4D4106005	B4D4106010
7	7.04-7.19	13	12.77-12.95	B4D4107001	B4D4107002	B4D4107003	B4D4107005	B4D4107010
8	8.04-8.19	14	13.77-13.95	B4D4108001	B4D4108002	B4D4108003	B4D4108005	B4D4108010
9	9.04-9.19	15	14.77-14.95	B4D4109001	B4D4109002	B4D4109003	B4D4109005	B4D4109010
10	10.04-10.19	16	15.77-15.95	B4D4110001	B4D4110002	B4D4110003	B4D4110005	B4D4110010
11	11.05-11.23	17	16.77-16.95	B4D4111001	B4D4111002	B4D4111003	B4D4111005	B4D4111010
12	12.05-12.23	18	17.77-17.95	B4D4112001	B4D4112002	B4D4112003	B4D4112005	B4D4112010
13	13.05-13.23	19	18.725-18.935	B4D4113001	B4D4113002	B4D4113003	B4D4113005	B4D4113010
14	14.05-14.23	20	19.725-19.935	B4D4114001	B4D4114002	B4D4114003	B4D4114005	B4D4114010
15	15.05-15.23	21	20.725-20.935	B4D4115001	B4D4115002	B4D4115003	B4D4115005	B4D4115010
16	16.05-16.23	22	21.725-21.935	B4D4116001	B4D4116002	B4D4116003	B4D4116005	B4D4116010
17	17.05-17.23	24	23.725-23.935	B4D4117001	B4D4117002	B4D4117003	B4D4117005	B4D4117010
20	20.065-20.275	28	27.725-27.935	B4D4120001	B4D4120002	B4D4120003	B4D4120005	B4D4120010
22	22.065-22.275	30	29.725-29.935	B4D4122001	B4D4122002	B4D4122003	B4D4122005	B4D4122010
25	25.065-25.275	35	34.67-34.92	B4D4125001	B4D4125002	B4D4125003	B4D4125005	B4D4125010
28	28.065-28.275	40	39.67-39.92	B4D4128001	B4D4128002	B4D4128003	B4D4128005	B4D4128010
30	30.065-30.275	42	41.67-41.92	B4D4130001	B4D4130002	B4D4130003	B4D4130005	B4D4130010
35	35.08-35.33	45	44.67-44.92	B4D4135001	B4D4135002	B4D4135003	B4D4135005	B4D4135010
40	40.08-40.33	50	49.67-49.92	B4D4140001	B4D4140002	B4D4140003	B4D4140005	B4D4140010
50	50.08-50.33	62	61.6-61.9	B4D4150001	B4D4150002	B4D4150003	B4D4150005	B4D4150010

Sizes in BLUE are non-preferred. Availability is limited and MOQ higher.

Data is strictly informative

Note: All Austenitic Stainless Steel Fasteners may exhibit some magnetic properties due to the manufacturing process.

Refer: ISO 3506-2 Annex F