



J.C. GUPTA & SONS

GSTIN : 29AABFJ2719C1ZO
IEC : 00710030274

Fastener Super Speciality

#7/A, Sree Venkateshwara Building, Sadar Patrapa Road, Bengaluru - 560002

41478141, 9880539870 www.jcfasteners.com sales@jcfasteners.com

DIN 580 LIFTING EYE BOLT CE Marked



Catalogue Data Sheet **B4A46-1** Stainless Steel A2/1.4301 (SS304)

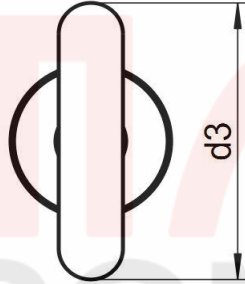
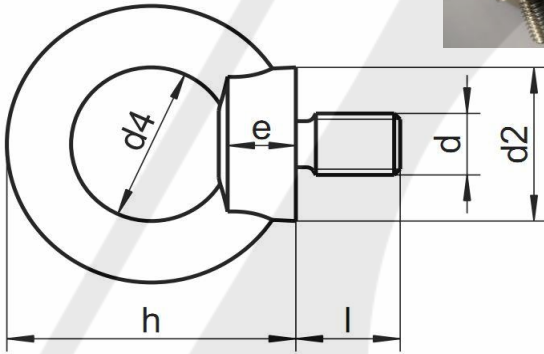
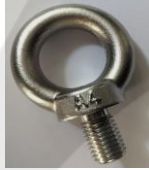

Quote the item code given below with your order/ inquiries:

Dimensions in mm

Nominal Size(d)	Item Code	Stem Length	Eye-ID	height	collar dia	collar ht	Eye-OD	WLL Kgs
Thread Size		l	d4	h	d2	e	d3	T
M6x1.0	B4A4606001	13	20.0	36.0	20.0	6.0	36.0	80
M8x1.25	B4A4608001	13	20.0	36.0	20.0	6.0	36.0	140
M10x1.5	B4A4610001	17	25.0	45.0	25.0	8.0	45.0	230
M12x1.75	B4A4612001	20	30.0	53.0	30.0	10.0	54.0	240
M14x2.0	B4A4614001	27	35.0	62.0	35.0	12.0	63.0	600
M16x2.0	B4A4616001	27	35.0	62.0	35.0	12.0	63.0	700
M20x2.5	B4A4620001	30	40.0	71.0	40.0	14.0	72.0	1200
M24x3.0	B4A4624001	36	50.0	90.0	50.0	18.0	90.0	1800
M27x3.0	B4A4627001	45	60.0	109.0	65.0	22.0	108.0	1800
M30x3.5	B4A4630001	45	60.0	109.0	65.0	22.0	108.0	3600
M36x4.0	B4A4636001	54	70.0	128.0	75.0	26.0	126.0	3600

Sizes in Blue are non preferred. Availability is limited and MOQ is higher

Data is strictly informative

Factor of Safety is 6

Note: All Austenitic Stainless Steel Fasteners may exhibit some magnetic properties due to the manufacturing process.

Refer: ISO 3506-2 Annex F