



Since : 1993

# J.C. GUPTA & SONS

Fastener Super Speciality

#7/A, Sree Venkateshwara Building, Sadar Patrapa Road, Bengaluru - 560002



41478141, 9880539870



www.jcfasteners.com



sales@jcfasteners.com

GSTIN : 29AABFJ2719C1ZO  
IEC : 00710030274

## DIN 127 B SPRING WASHER FLT

BLACK



Catalogue Data Sheet **B9D06**

AISI 301

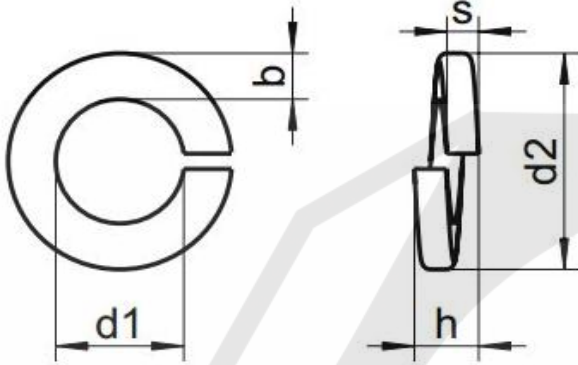

Quote the item code given below with your order/ inquiries:

Dimensions in MM

| Nominal Size     | Item Code          | Inside Diameter d1 |      |        | Outside Diameter | Height h |       | Width b |      | Thickness s |     |
|------------------|--------------------|--------------------|------|--------|------------------|----------|-------|---------|------|-------------|-----|
|                  |                    | min                | max  | d2 max |                  | min      | max   | min     | max  | min         | max |
| <b>Bolt Size</b> | <b>PART NUMBER</b> |                    |      |        |                  |          |       |         |      |             |     |
| M2               | U9D0602000         | 2.1                | 2.4  | 4.4    | 1.0              | 1.2      | 0.80  | 1.00    | 0.40 | 0.60        |     |
| M2.2             | U9D0620200         | 2.3                | 2.6  | 4.8    | 1.0              | 1.2      | 0.90  | 1.10    | 0.50 | 0.70        |     |
| M2.5             | U9D0620500         | 2.6                | 2.9  | 5.1    | 1.2              | 1.4      | 0.90  | 1.10    | 0.50 | 0.70        |     |
| M3               | U9D0603000         | 3.1                | 3.4  | 6.2    | 1.6              | 1.9      | 1.20  | 1.40    | 0.70 | 0.90        |     |
| M3.5             | U9D0630500         | 3.6                | 3.9  | 6.7    | 1.6              | 1.9      | 1.20  | 1.40    | 0.70 | 0.90        |     |
| M4               | U9D0604000         | 4.1                | 4.4  | 7.6    | 1.8              | 2.1      | 1.40  | 1.60    | 0.80 | 1.00        |     |
| M5               | U9D0605000         | 5.1                | 5.4  | 9.2    | 2.4              | 2.8      | 1.70  | 1.90    | 1.10 | 1.30        |     |
| M6               | U9D0606000         | 6.1                | 6.5  | 11.8   | 3.2              | 3.8      | 2.35  | 2.65    | 1.50 | 1.70        |     |
| M7               | U9D0607000         | 7.1                | 7.5  | 12.8   | 3.4              | 4.2      | 2.35  | 2.65    | 1.50 | 1.70        |     |
| M8               | U9D0608000         | 8.1                | 8.5  | 14.8   | 4.0              | 4.7      | 2.85  | 3.15    | 1.90 | 2.10        |     |
| M10              | U9D0610000         | 10.2               | 10.7 | 18.1   | 4.4              | 5.2      | 3.30  | 3.70    | 2.05 | 2.35        |     |
| M12              | U9D0612000         | 12.2               | 12.7 | 21.1   | 5.0              | 5.9      | 3.80  | 4.20    | 2.35 | 2.65        |     |
| M14              | U9D0614000         | 14.2               | 14.7 | 24.1   | 6.0              | 7.1      | 4.30  | 4.70    | 2.85 | 3.15        |     |
| M16              | U9D0616000         | 16.2               | 17.0 | 27.4   | 7.0              | 8.3      | 4.80  | 5.20    | 3.30 | 3.70        |     |
| M18              | U9D0618000         | 18.2               | 19.0 | 29.4   | 7.0              | 8.3      | 4.80  | 5.20    | 3.30 | 3.70        |     |
| M20              | U9D0620000         | 20.2               | 21.2 | 33.6   | 8.0              | 9.4      | 5.80  | 6.20    | 3.80 | 4.20        |     |
| M22              | U9D0622000         | 22.5               | 23.5 | 35.9   | 8.0              | 9.4      | 5.80  | 6.20    | 3.80 | 4.20        |     |
| M24              | U9D0624000         | 24.5               | 25.5 | 40.0   | 10.0             | 11.8     | 6.75  | 7.25    | 4.80 | 5.20        |     |
| M27              | U9D0627000         | 27.5               | 28.5 | 43.0   | 10.0             | 11.8     | 6.75  | 7.25    | 4.80 | 5.20        |     |
| M30              | U9D0630000         | 30.5               | 31.7 | 48.2   | 12.0             | 14.2     | 7.75  | 8.25    | 5.80 | 6.20        |     |
| M33              | U9D0633000         | 33.5               | 34.7 | 55.2   | 12.0             | 14.2     | 9.75  | 10.25   | 5.80 | 6.20        |     |
| M36              | U9D0636000         | 36.5               | 37.7 | 58.2   | 12.0             | 14.2     | 9.75  | 10.25   | 5.80 | 6.20        |     |
| M39              | U9D0639000         | 39.5               | 40.7 | 61.2   | 12.0             | 14.2     | 9.75  | 10.25   | 5.80 | 6.20        |     |
| M42              | U9D0642000         | 42.5               | 43.7 | 68.2   | 14.0             | 16.5     | 11.75 | 12.25   | 6.75 | 7.25        |     |
| M45              | U9D0645000         | 45.5               | 47.0 | 71.2   | 14.0             | 16.5     | 11.75 | 12.25   | 6.75 | 7.25        |     |
| M48              | U9D0648000         | 49.0               | 50.5 | 75.0   | 14.0             | 16.5     | 11.75 | 12.25   | 6.75 | 7.25        |     |

Sizes in Blue are non preferred. Availability may be limited and MOQ higher

Data is strictly informative

**Note:** All Austenitic Stainless Steel Fasteners may exhibit some magnetic properties due to the manufacturing process. Refer: ISO 3506-2 Annex F