



Since : 1993

J.C. GUPTA & SONS

Fastener Super Speciality

GSTIN : 29AABFJ2719C1ZO
IEC : 00710030274

#7/A, Sree Venkateshwara Building, Sadar Patrappa Road, Bengaluru - 560002

41478141, 9880539870 www.jcfasteners.com sales@jcfasteners.com

Clinch Floating Lock Nut LAC

Unified Series

For use in Steel Sheets max HRB 70



Catalogue Datasheet **B4uC77**

Stainless Steel A2

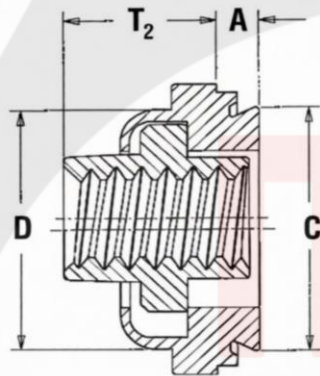
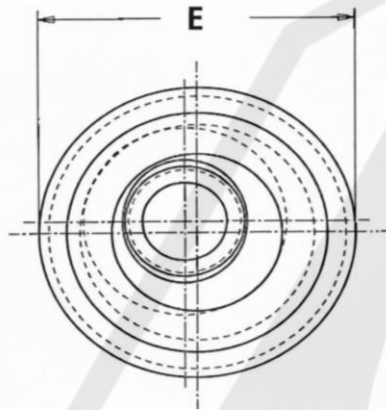

Size →	#4-40	#6-32	#8-32	#10-24	#10-32	1/4"-20	1/4"-28
C max	0.289	0.327	0.367	0.406	0.406	0.514	0.514
D max	0.290	0.335	0.365	0.406	0.406	0.510	0.510
E ± 0.015	0.360	0.390	0.440	0.470	0.470	0.600	0.600
T2 Max	0.195	0.205	0.215	0.275	0.275	0.315	0.315
Hole size in sheet + 0.003	0.290	0.328	0.368	0.406	0.406	0.515	0.515
Min dist hole centre to edge	0.30	0.32	0.34	0.36	0.36	0.42	0.42

Quote the item code given below with your order/ inquiries:

Dimensions in inches

Size	Shank Code	Item Code	Sheet Thickness	Shank A	Installation Force lbs		Pushout Force lbs	
			Min	Max	5052 AL	ST	5052 AL	ST
#4-40	1	B4uC7744001	0.038	0.038	1500	3000	215	300
	2	B4uC7744002	0.054	0.054	2000		225	
#6-32	1	B4uC7763201	0.038	0.038	2000	3000	240	300
	2	B4uC7763202	0.054	0.054			250	
#8-32	1	B4uC7783201	0.038	0.038	2000	3000	250	300
	2	B4uC7783202	0.054	0.054			265	
#10-24	1	B4uC7712401	0.038	0.038	2000	3500	300	400
	2	B4uC7712402	0.054	0.054			350	
#10-32	1	B4vC7713201	0.038	0.038	2000	3500	300	400
	2	B4vC7713202	0.054	0.054			350	
1/4"-20	2	B4uC7762002	0.054	0.054	3000	5000	400	500
1/4"-28	2	B4vC7762002	0.054	0.054	3000	5000	400	500

Sizes in BLUE are non-preferred. Availability is limited and MOQ is higher.

Data is strictly informative

Note: All Austenitic Stainless Steel Fasteners may exhibit some magnetic properties due to the manufacturing process.

Refer: ISO 3506-2 Annex F